



CCR-49DR/DF



Curved corner design creates a stylish appearance and reduces chances of injury in slip-and-fall accidents.

CCR SERIES

Curved Corner Solid Door Reach-ins

REFRIGERATORS

- CCR-23SR
- CCR-49DR
- CCR-72TR

FREEZERS

- CCR-23SF
- CCR-49DF
- CCR-72TF

CCR freezers approved by California Appliance Energy Regulations

(Title 20, Section 1604a and 1605.3a)

FEATURES

STANDARD ELECTRONIC CONTROL

- Increases efficiency, reliability and convenience
- Allows user to easily monitor and adjust defrost functions and temperature settings from the panel interface
- Decreases service time and calls
- Door open alarm that sounds after door is open more than 30 seconds



CONSTRUCTION

- Design meets NSF 7 criteria
- All stainless steel construction except for aluminum top and back
- Four adjustable heavy-duty vinyl coated wire shelves per door
- 2" thick side and back walls are foamed-in-place with "low ODP" urethane insulation

DOORS

- Standard recessed handle
- Self-closing doors with stop function
- Door swing:
 - CCR-23SR/SF hinged right
 - CCR-49DR/DF..... left door hinged left, right door hinged right
 - CCR-72TR/TF..... left door hinged left, middle door hinged right, right door hinged right
- Anti-condensate door frame heaters
- 1³/₄" stainless steel foamed-in-place doors
- Door width: 27"

REFRIGERATION

- Refrigerant:
 - CCR-23SR, CCR-49DR, CCR-72TR R-134a
 - CCR-23SF, CCR-49DF, CCR-72TF R-404A
- Self-contained, no plumbing required
- Designed with food service consultants in mind
- Oversized and balanced system to guarantee consistent interior temperatures

- Bottom mounted compressor
- Temperature range:
 - CCR-23SR, CCR-49DR, CCR-72TR 33 to 41°F (1° to 5°C)
 - CCR-23SF, CCR-49DF, CCR-72TF 0° to -10°F (-18° to -24°C)
- R-factor (insulation efficiency rating): 16.67

WARRANTY

- Standard limited four year extended compressor and one year limited parts and labor

OPTIONS

- Leg kit
- Extra stainless steel wire shelves
- Extra epoxy-coated wire shelves
- Pan racks



CCR SERIES CURVED CORNER SOLID DOOR REACH-INS

TECHNICAL SPECIFICATIONS

MODEL	DIMENSIONS (in.)			DIMENSIONS (mm)			VOLTS	AMPS	UNIT H.P.	NO. OF DOORS	NO. OF SHELVES	STANDARD SHELF SIZE (in inches)	CAP. CU. FT.	SHIP CU. FT.	SHIP WT. (LB/KG)
	L	D	H*	L	D	H*									
REFRIGERATORS															
CCR-23SR	27	30 ¹ / ₂	83	686	775	2108	115	5.5	1/3	1	4	21 ⁵ / ₈ x 23 ¹ / ₄	23.0	55.0	295/134
CCR-49DR	54 ³ / ₈	30 ¹ / ₂	83	1381	775	2108	115	9.2	1/3	2	8	24 ³ / ₈ x 23 ¹ / ₄	49.0	108.0	450/205
CCR-72TR	81 ⁷ / ₈	30 ¹ / ₂	83	2080	775	2108	115	9.7	1/2	3	12	24 ³ / ₈ x 23 ¹ / ₄	73.0	130.8	595/270
FREEZERS															
CCR-23SF	27	30 ¹ / ₂	83	686	775	2108	115	7.8	1/3	1	4	21 ⁵ / ₈ x 23 ¹ / ₄	23.0	55.0	330/150
CCR-49DF	54 ³ / ₈	30 ¹ / ₂	83	1381	775	2108	115	10.3	1/2	2	8	24 ³ / ₈ x 23 ¹ / ₄	49.0	108.0	510/232
CCR-72TF	81 ⁷ / ₈	30 ¹ / ₂	83	2080	775	2108	115/208-230	11.0	1	3	12	24 ³ / ₈ x 23 ¹ / ₄	73.0	130.8	670/305

*Height includes casters.

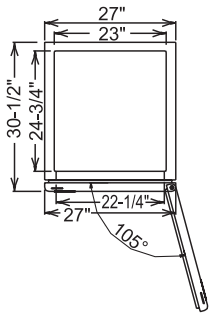

CCR-27SR/SF
PLAN VIEW

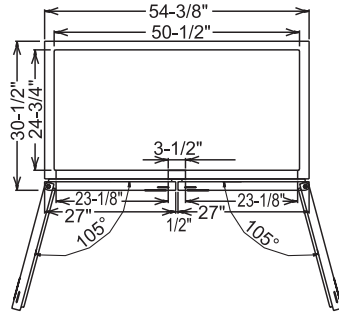

CCR-49DR/DF
PLAN VIEW

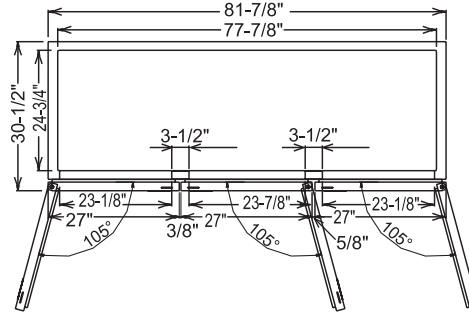

CCR-72TR/TF
PLAN VIEW

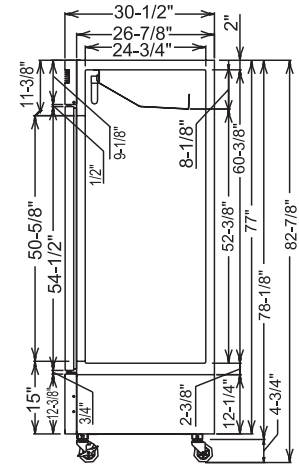

SIDE VIEW

LISTINGS



HOOKUP

Via plug in flexible 16/3 cord with molded plug. Cord is 7 feet long on single door models, 5 feet long on double door models, 8 feet long on triple door refrigerator and 10 feet long on triple door freezer.

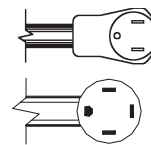

NEMA 5-15P (All models except CCR-72TF)

NEMA 14-20P (CCR-72TF)

BID SPECIFICATIONS

Item no. CCR-_____ Provide _____ () Curved Corner Solid Door Reach-in(s), Master-Bilt model no. CCR-_____.

Reach-in to be provided with all stainless steel construction (except for aluminum top and back), rounded corners and four adjustable heavy-duty vinyl coated wire shelves per door.

Reach-in refrigerators and freezers will be equipped with an electronically con-

trolled system with alarm function.

Reach-in doors will have a standard recessed handle and be self-closing with stop function. In addition, the doors will contain anti-condensate frame heaters and be urethane foamed-in-place.

The refrigeration system is to be bottom-mounted and self-contained. Refrigerators will contain R-134a refrigerant while freezers will have R-404A. The temperature ranges will be 33° to 41°F (1° to 5°C) for

refrigerators and 0° to -10°F (-18° to -24°C) for freezers.

All models to have standard limited four year extended compressor and one year limited parts and labor warranty. All models also to be UL, C-UL, NSF listed and Energy Star certified. Freezers approved by California Appliance Energy Regulations (title 20, section 1604a and 1605.3a).

NOTE: Cabinet designed for optimum performance in air-conditioned area at 75°F ambient and 55% relative humidity. All specifications subject to change without notice.



908 Highway 15 North • New Albany, MS 38652
PHONE: 800-647-1284 or 662-534-9061 • FAX: 800-232-3966 or 662-534-6049 • www.master-bilt.com

