

SMC-122

## SMC SERIES

### Slide Top Milk Coolers

**Available on a special order basis.  
 Contact factory for details.**

#### MODELS

- SMC-122
- SMC-162

## FEATURES

#### CONSTRUCTION

- Top slide doors with stainless steel exterior
- White enamel painted steel exterior
- Galvanized steel interior including door interior
- Four 4" easy-roll swivel casters (two locking)
- Heavy-duty floor racks
- Reinforced base to maintain cooler integrity when fully loaded
- 2 1/2" fiberglass insulation
- NSF-listed drain
- NSF-listed thermometer

#### REFRIGERATION

- Self-contained, bottom mount
- Powerful, large-capacity system allows cooler to maintain proper temperature for longer amount of time with doors open
- Cold wall evaporator with no moving parts which allows more storage space
- Refrigerant: R-22
- Operating temperature: 38°F (3°C)

#### WARRANTY

- Standard limited four year extended compressor and one year limited parts and labor

## CAPACITY

MODEL	CASES WITH CARTONS				LOOSE CARTON (WITHOUT CASES)	
	13" x 13" x 11"H		19" x 13" x 11"H		1/2 PINT	1 PINT
	CASES	CARTONS	CASES	CARTONS		
SMC-122	12	528	8	576	1296	649
SMC-162	16	704	12	864	1800	900

## OPTIONS

- Add "SS" for stainless steel interior and exterior
- Locking bar
- (4) six-inch adjustable legs



# SMC SERIES SLIDE TOP MILK COOLERS

## TECHNICAL SPECIFICATIONS

MODEL	DIMENSIONS (in.)			DIMENSIONS (mm)			VOLTS	AMPS	UNIT H.P.	NO. OF FLOOR RACKS	CAP. CU. FT.	SHIP CU. FT.	SHIP WT. LB/KG
	L	D	H*	L	D	H*							
SMC-122	48	33 <sup>1</sup> / <sub>2</sub>	43	1219	851	1092	115	5.0	1/5	3	16	46.3	378/172
SMC-162	63	33 <sup>1</sup> / <sub>2</sub>	43	1600	851	1092	115	5.0	1/5	4	22	59.9	400/182

\*Height includes casters.

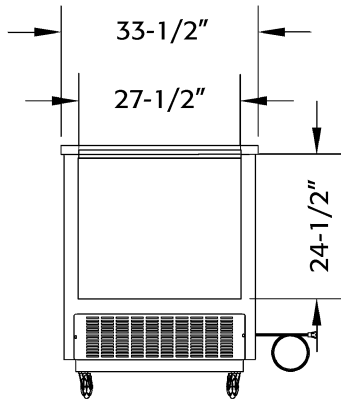

SIDE VIEW

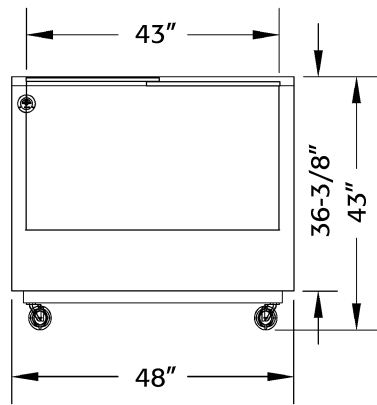

SMC-122  
ELEVATION VIEW

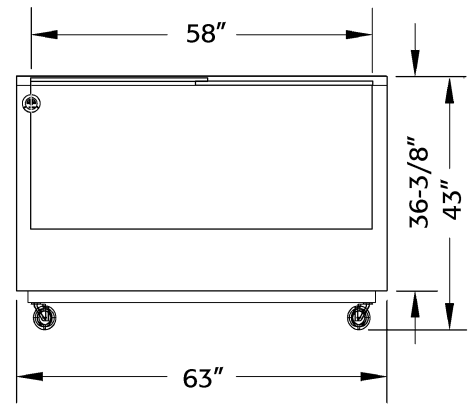

SMC-162  
ELEVATION VIEW

## LISTINGS



## HOOKUP

Via plug in, 7 foot long flexible three wire 16 gauge cord with molded plug.



## BID SPECIFICATIONS

Item no. SMC- \_\_\_\_\_  
Provide \_\_\_\_\_ ( )  
Slide Top Milk Cooler(s), Master-Bilt  
model no. SMC- \_\_\_\_\_ .

Milk cooler to be constructed of white enamel painted steel on the exterior with galvanized steel interior. Top sliding doors to be stainless steel on the exterior with galvanized steel interior. Cooler to be provided with four swivel casters (two

locking) and an NSF-listed floor drain and thermometer. Additionally, cooler will contain heavy-duty epoxy-coated floor racks and a reinforced base to maintain cooler integrity when fully loaded. Insulation will consist of 2<sup>1</sup>/<sub>2</sub>" thick fiberglass.

The refrigeration system will be self-contained, bottom mounted with a cold wall evaporator. System will contain R-22 refrigerant. The operating temperature

will be 38°F (3°C).

Cooler to have standard limited four year extended compressor warranty and one year limited parts and labor warranty.

Cooler to be UL and C-UL listed as well as UL EPH classified.

**NOTE:** Cabinet designed for optimum performance in air-conditioned area at 75°F ambient and 55% relative humidity. All specifications subject to change without notice.



908 Highway 15 North • New Albany, MS 38652  
PHONE: 800-647-1284 or 662-534-9061 • FAX: 800-232-3966 or 662-534-6049 • www.master-bilt.com

