

Project:

Quantity:

Item #:

Model Specified:

# TURBO AIR'S UNIQUE ENERGY SAVING DESIGN!

## One and Two Door Models

CABINET INTERIOR/EXTERIOR SPECIFICATIONS

*\* Back Splash Guard.- Option*



TUF-48SD



TUF-28SD



### Undercounter Freezer TUF-28SD, TUF-48SD

Exterior cabinet including top, doors, and sides are constructed of high quality stainless steel.

• **New NSF standard 7**

Complies with and listed under ANSI / NSF-7

• **Excellent Cooling System**

The powerful forced-air refrigeration system holds storage cabinet in a constant temperature. Evaporator fans and a newly designed louver allows uniform distribution of cold air to keep the food temperature within the New NSF Standard 7.

• **All Exterior Stainless Steel Construction**

Will ensure a bright, dent resistant and durable finish for years to come.

• **Clean Interior**

We use harmless ABS sheet and highly dense polyurethane, forming perfectly to keep the cool air inside and makes it easy to clean without any joint-gaps.

• **Incandescent Interior Lighting**

• **Adjustable Stainless Steel Wire Shelves**

Durable, and easy to adjust

• **Stainless steel Louver**

Stainless steel Louver allows distribution of cold air to reach all corners of the unit. It is also built to withstand against food acids and stains, which makes for easy clean up.

• **Self-Contained System**

No plumbing required.

• **Recessed Handles**

Turbo Air's recessed handle enhances our products aesthetically and functionally.

• **Casters Standard**

5" Casters.

• **Option**

Back Splash Guard order available.

• **18 Month Labor and Part Warranty for Super Deluxe series**

• **CEC California Energy Commission Certificated**



LISTED  
COMMERCIAL  
REFRIGERATOR  
AND/OR FREEZER  
43BK



ISO9001



1250 Victoria St. CARSON, CA 90746  
Toll Free (800)627-0032 www.turboairinc.com

Project:	Quantity:	Item #:
Model Specified:		

# One and Two Door Models

## CABINET INTERIOR/EXTERIOR SPECIFICATIONS

(Unit : inch)

MODEL	TUF-28SD	TUF-48SD
Exterior Dimensions(LxDxH)	27.8" x 30" x 36"	48.2" x 30" x 36"
Capa. Cubic FT.	6.5	12
Comp.	1/4 HP	1/3 HP
Temp.	5°F~ -15°F	5°F~ -15°F
Shelves	2 ea	4 ea
Weight	190 lbs	260 lbs
Power	115V / 60 Hz	115V / 60 Hz
Amp.	7.5 A	11.5 A
Lamp	25 W	25 W
Cord Length	9.85 Feet	9.85 Feet
Plug-In	Nema 5-15P	Nema 5-15P

*\*Design and specifications can be changed without prior notice for product improvement.*

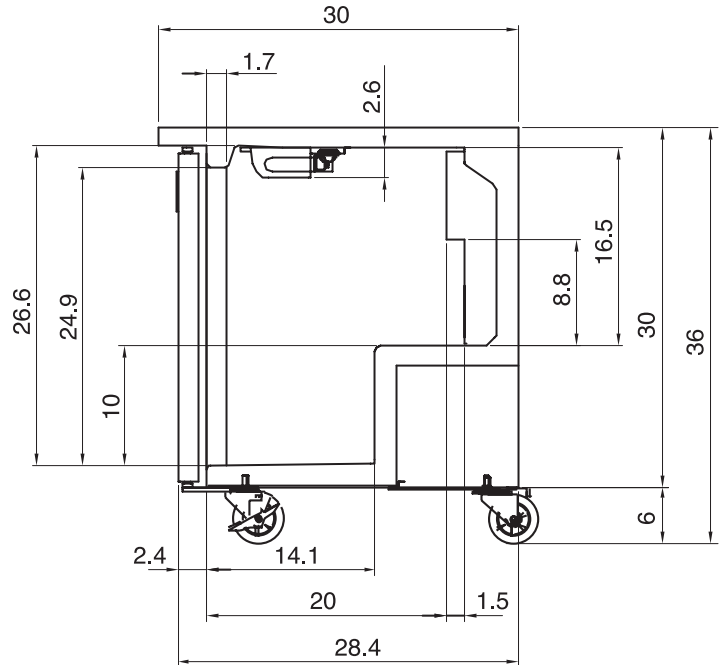

ONE & TWO DOOR SIDE VIEW

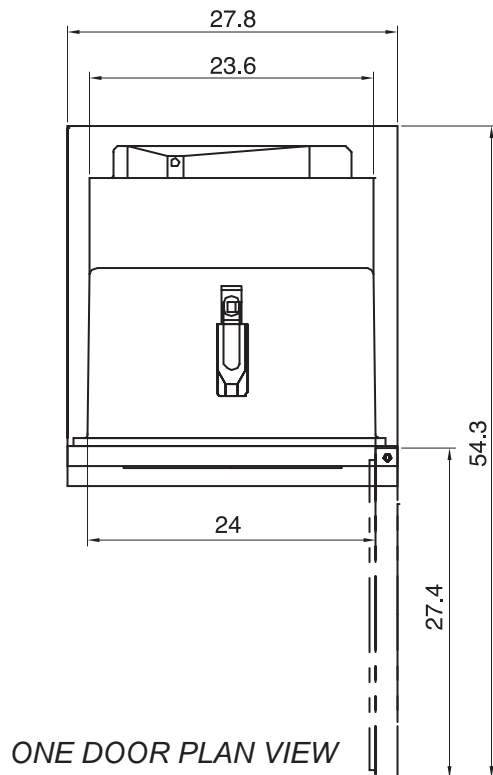

ONE DOOR PLAN VIEW

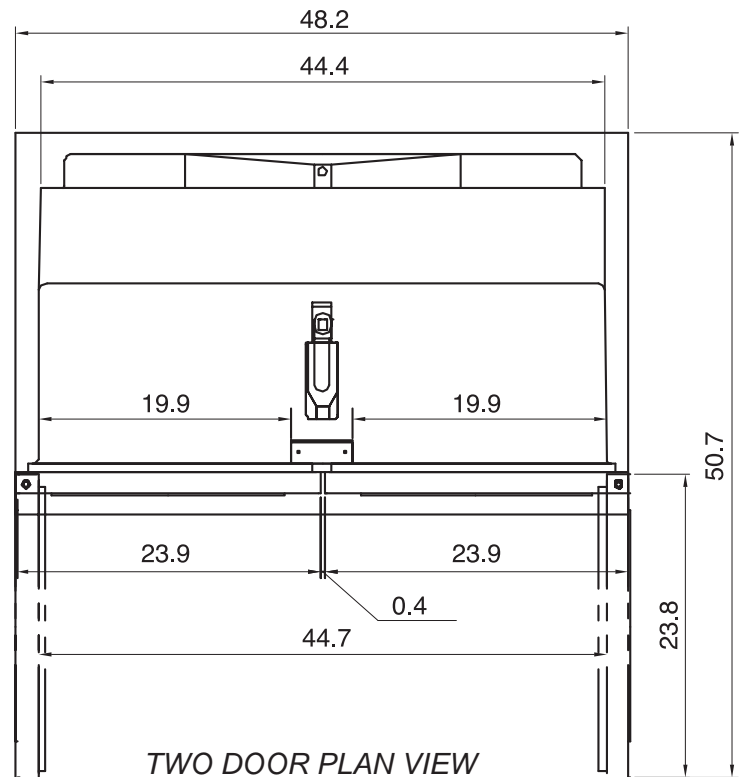

TWO DOOR PLAN VIEW